



SikaRoof[®] BOARD ADHESIVE

ADHESIVE TO BOND THERMAL INSULATION BOARDS TO VARIOUS SUBSTRATES

BUILDING TRUST



SikaRoof® BOARD ADHESIVE

APPLICATION REFERENCE



V-Bahn Grindelwald, Switzerland.



SikaRoof® BOARD ADHESIVE

GENERAL PRODUCT INFORMATION

READY TO USE POLYURETHANE FOAM SikaRoof® BOARD ADHESIVE. Compared to conventional products, the adhesive is particularly efficient during application, which can save up to 30% of the installation time! SikaRoof® Board Adhesive is a ready to use, one component PU adhesive, and does not require any substrate primers. Thanks to the good initial adhesion, thermal insulation boards can be bonded quickly and reliably in a very short time. Position corrections are possible within the skin formation time of seven minutes. SikaRoof® Board Adhesive has good adhesive tensile strength and wind suction stability and thus ensures great safety during installation. One can of 750 milliliters can adhere up to 48 linear meter (approx. 18 m²).

SikaRoof® Board Adhesive



DESCRIPTION

SikaRoof® Board Adhesive is a polyurethane 1-part, fast curing, gun grade, foam adhesive that bonds insulation boards to various types of construction material substrates.

USES

Insulation board types:

- Extruded polystyrene boards (XPS)
- Expanded polystyrene boards (EPS)
- PUR / PIR boards
- Mineral fibre boards with sufficient compressive strength and appropriate type of bonding surface

SUBSTRATES:

- Concrete, lightweight concrete
- OSB boards, plywood panels, timber boards
- Fiber cement boards
- Mineral or sand-surfaced bitumen
- Galvanized or coated steel and zinc metal
- Vapour control layer (Sarnavap®-5000 E SA / SikaShield® VB)



Features	Advantages	Benefits
One container covers an area up to 18 m ²	Less product change during the application	Efficient application method
1cPU Product	<ul style="list-style-type: none"> ■ No mixing needed to start the application ■ Wireless application method 	Easy, efficient and clean application method
HFC-Free	Contains no halogenic ingredients	Save solution regarding health and safety
Fire behavior B1	Meets the highest fire standard	Save solution in case of fire
Good adhesion to various substrates	One product for all applications	Save and ease product and system evaluation
Fast curing time	Waterproofing membrane installation can be continued after short time of period.	Fast application method

Spray Application Gun

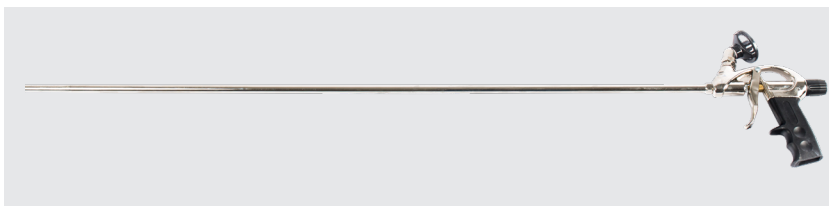

USES

Spray gun to be used for the application of SikaRoof® Board Adhesive, polyurethane 1-part, foam adhesive.

SYSTEM PRODUCT

SikaRoof® Board Adhesive

SikaRoof® BOARD ADHESIVE

FOAM ADHESIVE APPLICATION

SikaRoof® BOARD ADHESIVE AND SPRAY APPLICATION GUN



1. Spray Application Gun
2. Spacer
3. Nozzle

FOAM ADHESIVE APPLICATION



1. Shake the can well approx. 30 times.

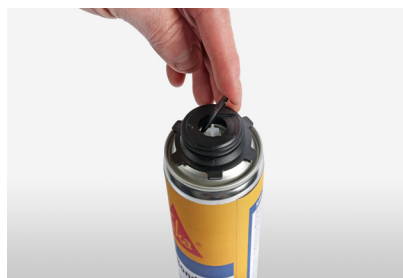

2. Remove small black lid from the top of the can.



3. Screw SikaRoof® Board Adhesive can into Spray Application Gun.



4. Apply the Flat Nozzle to the end of Spray Application Gun.



5. SikaRoof® Board Adhesive is ready to use. The amount of expanding foam can be adjusted by applying more or less pressure on the trigger.



6. Attach the Spacer to the end of the Spray Application Gun. That will maintain the right distance between the nozzle and a substrate.



7. Apply SikaRoof® Board Adhesive directly onto the surface, then quickly press the thermal insulation board onto the flat roof with light pressure and adjust.



8. Clean all the tools and the Spray Application Gun with Sika® Boom Cleaner right after use. Uncleaned Spray Application Gun will be blocked and unfit for next application.

Important

SikaRoof® Board Adhesive must be applied according to the requirement of windload zones. Roof windload must not exceed 2.4 kN/m². For windload zones above 2.4 kN/m² contact Sika technical service for further advice. Theoretical number of beads for a flat surface.

Middle zone	3 beads per m ²
Perimeter zone	4 beads per m ²
Corner zone	5 beads per m ²

The actual number of adhesive beads required may vary depending on windload calculation. On trapezoidal metal deck substrates use a minimum of one adhesive bead per crown except for when using mineral wool thermal insulation boards, where a minimum of two beads per crown must be used.

SikaRoof® BOARD ADHESIVE

POSSIBLE ROOF WATERPROOFING SOLUTIONS ON NEW ROOFS WITH FOAM ADHESIVE APPLICATION

ADHERED ROOF SYSTEM ON CONCRETE DECK

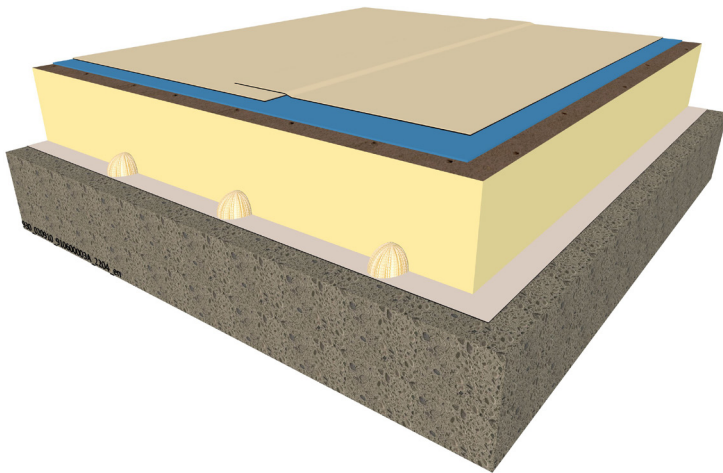

- Adhered roof waterproofing membrane
- Thermal insulation
- **SikaRoof® Board Adhesive** - beads applied
- Adhered vapour control layer
- Concrete deck

ADHERED ROOF SYSTEM ON METAL DECK

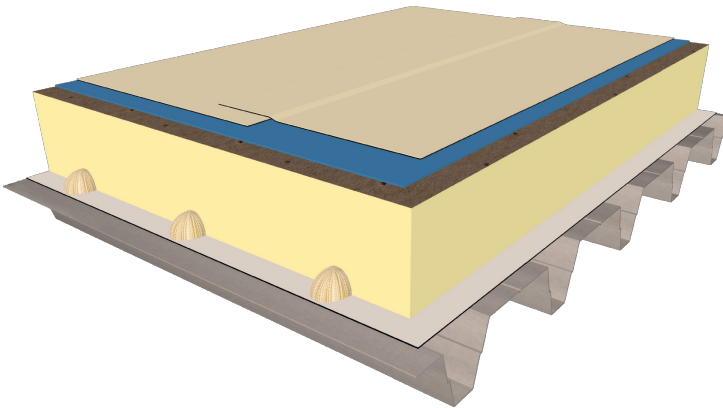

- Adhered roof waterproofing membrane
- Thermal insulation
- **SikaRoof® Board Adhesive** - beads applied
- Adhered vapour control layer
- Metal deck

ADHERED ROOF SYSTEM ON WOOD DECK

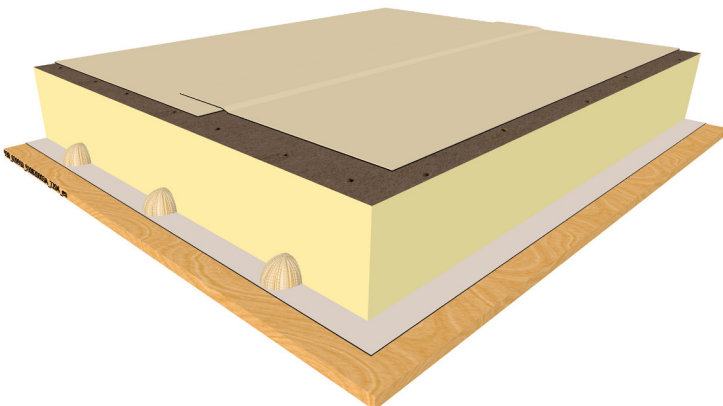

- Adhered roof waterproofing membrane
- Thermal insulation
- **SikaRoof® Board Adhesive** - beads applied
- Adhered vapour control layer
- Wood deck

SikaRoof® BOARD ADHESIVE

POSSIBLE ROOF WATERPROOFING SOLUTIONS ON EXISTING ROOFS WITH FOAM ADHESIVE APPLICATION

ADHERED ROOF SYSTEM ABOVE EXISTING FIBRE CEMENT CORRUGATED SHEETS (REFURBISHMENT)

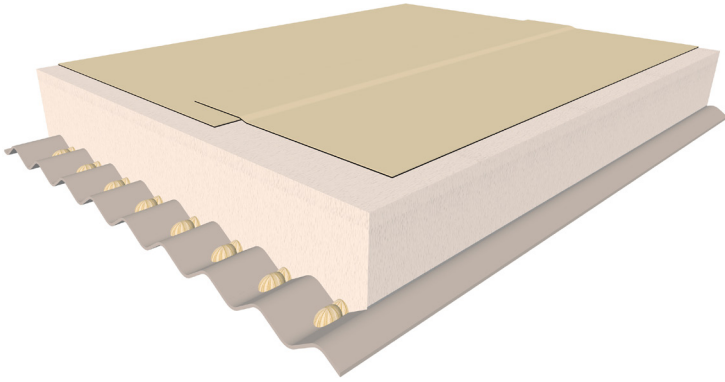

- Adhered roof waterproofing membrane
- Thermal insulation
- **SikaRoof® Board Adhesive** - beads applied
- Existing fibre cement corrugated sheets

ADHERED ROOF SYSTEM ABOVE EXISTING SANDWICH PANEL (REFURBISHMENT)

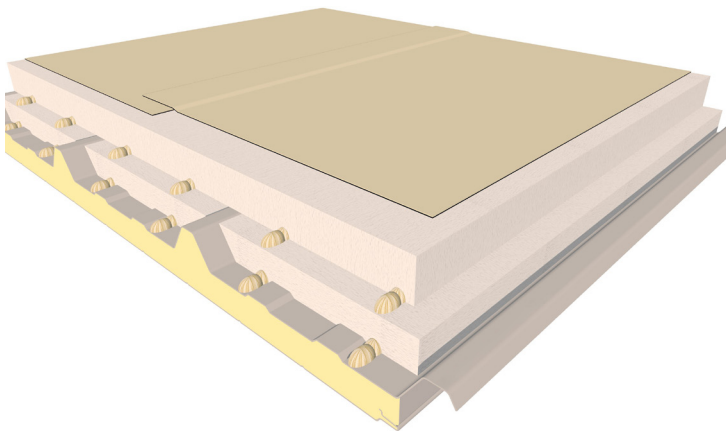

- Adhered roof waterproofing membrane
- Thermal insulation
- **SikaRoof® Board Adhesive** - beads applied
- Thermal insulation
- **SikaRoof® Board Adhesive** - beads applied
- Existing sandwich panels

ADHERED ROOF SYSTEM ABOVE EXISTING BITUMINOUS ROOF WATERPROOFING SYSTEM (REFURBISHMENT)

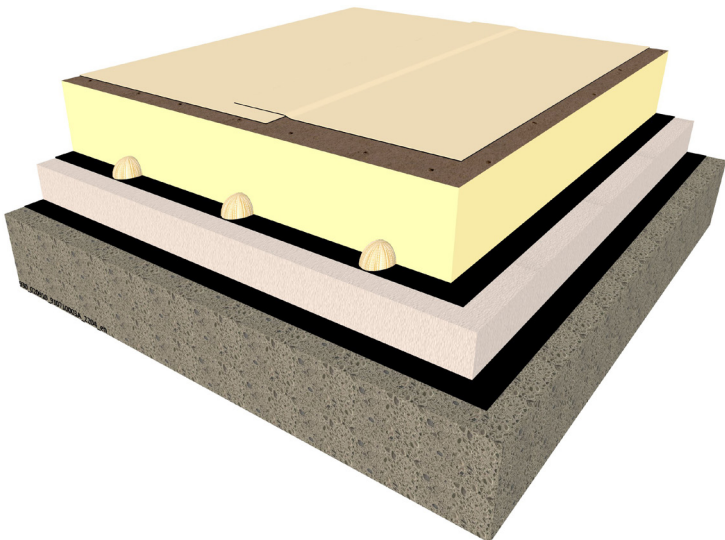

- Adhered roof waterproofing membrane
- Thermal insulation
- **SikaRoof® Board Adhesive** - beads applied
- Existing bituminous roof waterproofing system

SikaRoof® BOARD ADHESIVE

POSSIBLE ROOF WATERPROOFING SOLUTIONS WITH FOAM ADHESIVE APPLICATION

ADHERED ROOF SYSTEM ON METAL DECK INCLUDING COVERBOARDS AND CONDUCTIVE MESH FOR LEAK DETECTION

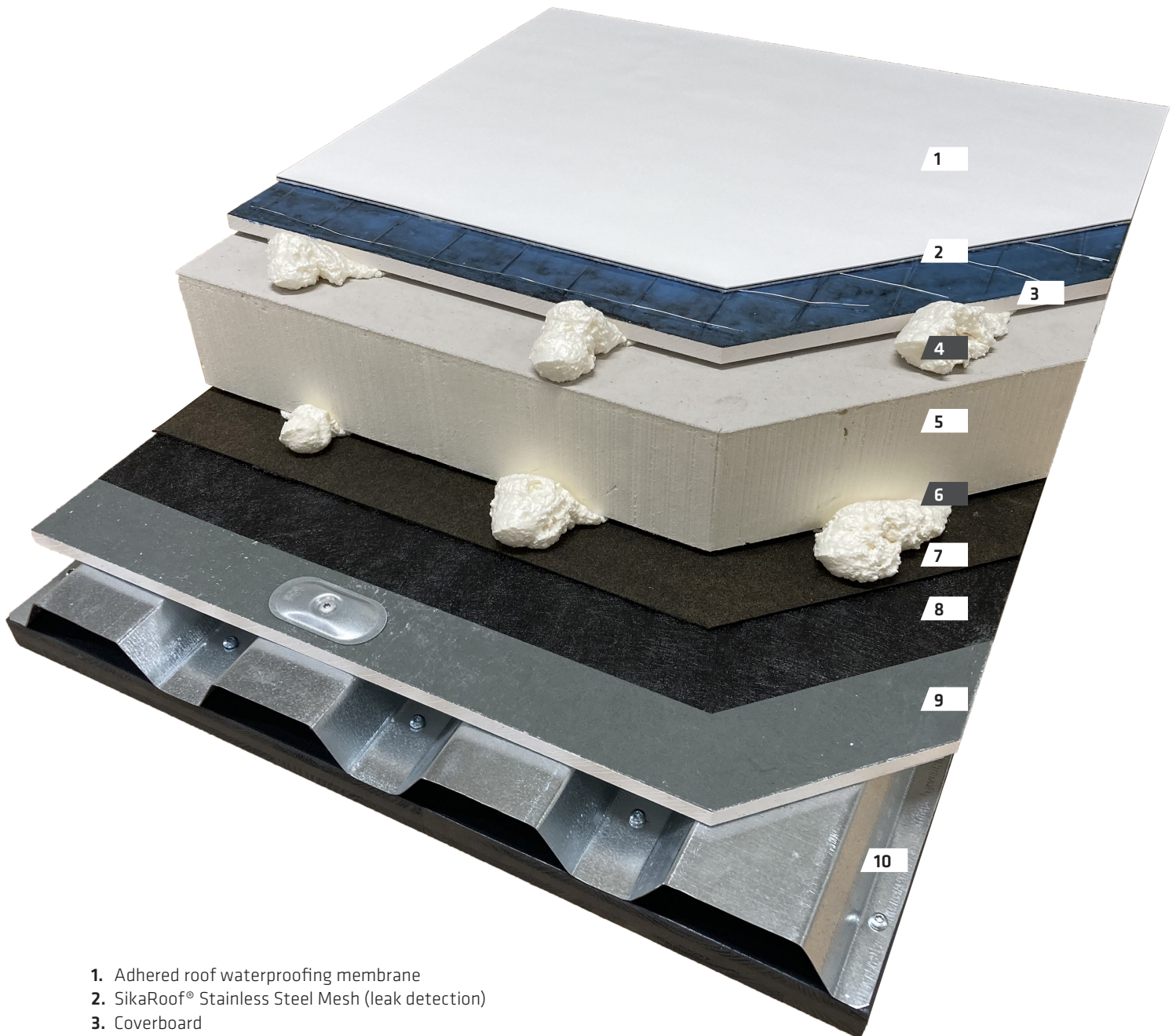

1. Adhered roof waterproofing membrane
2. SikaRoof® Stainless Steel Mesh (leak detection)
3. Coverboard
4. **SikaRoof® Board Adhesive** - beads applied
5. Thermal insulation
6. **SikaRoof® Board Adhesive** - beads applied
7. Bituminous vapour control layer (self adhered or torch applied)
8. Primer
9. Coverboard (mechanically fastened)
10. Metal deck

ALSO AVAILABLE FROM SIKA

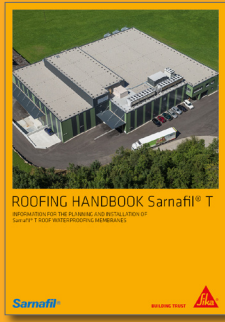
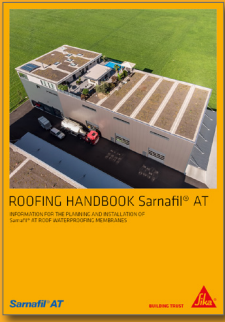

FOR MORE ROOFING INFORMATION:



WE ARE SIKA

Sika is a specialty chemicals company with a leading position in the development and production of systems and products for bonding, sealing, damping, reinforcing and protecting in the building sector and the motor vehicle industry. Sika's product lines feature concrete admixtures, mortars, sealants and adhesives, structural strengthening systems, flooring as well as roofing and waterproofing systems.

Our most current General Sales Conditions shall apply. Please consult the most current local Product Data Sheet prior to any use.



SIKA SERVICES AG
Tueffenwies 16
CH-8048 Zurich
Switzerland

Contact
Phone: +41 58 436 40 40
www.sika.com

BUILDING TRUST

